

## 圓頭扁平電線 / Round-end Flat Cable (RFC)

<b>RFC SPECIFICATION / 技術參數</b>		
<b>Insulation Film</b>	絕緣薄膜	<b>Kapton (PI膠膜) / Nomex紙膜 / PET膠膜</b>
<b>Conductor Pitch</b>	導體間距	<b>1.27mm / 2.0mm / 2.54mm</b>
<b>NO. Of Conductor</b>	導體數量	<b>2~50 Pin</b>
<b>Round end Dia.</b>	圓頭直徑(O.D.)	<b>1.27mm Pitch =&gt; 圓頭直徑O.D. 0.3mm 2.0mm Pitch =&gt; 圓頭直徑 O.D. 0.3mm or 0.4mm 2.54mm Pitch =&gt; 圓頭直徑 O.D. 0.5mm</b>
<b>Total Length</b>	長度(L)	<b>10~3000mm</b>
<b>Color</b>	顏色	<b>Kapton (PI膠膜) =&gt; 黃色 Yellow Nomex紙膜 =&gt; 白色 White PET膠膜 =&gt; 白色 White / 黑色 Black</b>
<b>Flammability Rating</b>	阻燃性	<b>UL94V-0</b>
<b>Equivalent Conductor Size</b>	線規	<b>24AWG</b>
<b>Temperature Rating</b>	耐溫	<b>80°C / 105°C / 300°C</b>
<b>Current Rating</b>	額定電流	<b>2A~6A</b>
<b>Voltage Rating</b>	額定電壓	<b>300V</b>
<b>Dielectric</b>	耐壓強度	<b>1000V~3000V / Min</b>

C052027-XXX-XX-XXX

SERIES NO.

PITCH

- 0: 1.27mm
- 1: 2.00mm
- 2: 2.54mm

OD

- 3: 0.3mm
- 4: 0.4mm
- 5: 0.5mm

TEMP

- 0: 80°C
- 1: 105°C
- 2: 300°C

PIN NO

XX: 02 ~ 50

LENGTH

XXX: 001CM ~ 300CM

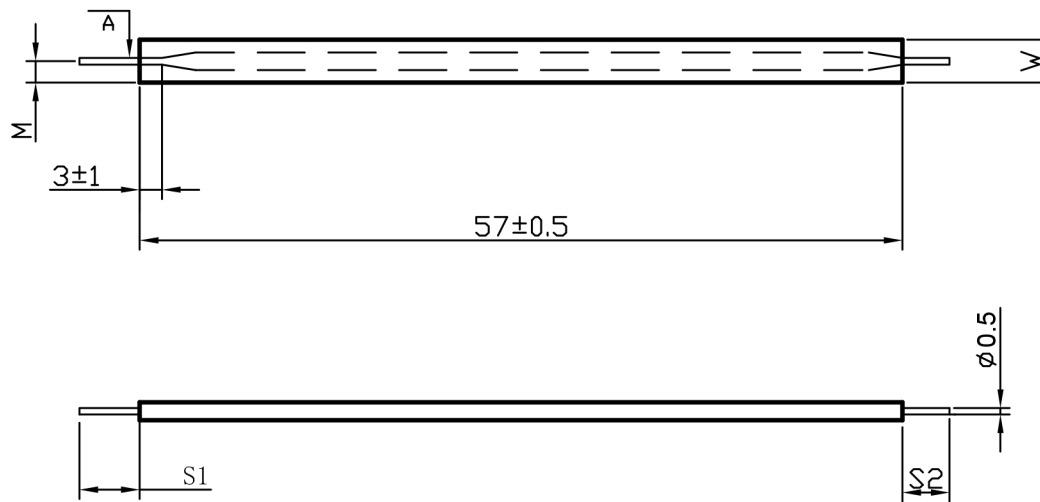

NOTE: W=1.3mm, H=0.15mm



A-A

Item	Symbol	Spec
No.of.Conductor (导体芯数)	N	1
Pitch (间距)	P	Nil
Total Width (总宽度)	W	3.2±0.2
Total Pitch (总间距)	TP	Nil
Margin(边缘宽度)	M	1.6±0.15
Total Length (总长度)	TL	64.8±0.5
Cable Thickness (线身厚度)	CT	0.15±0.05
Conductor Strip Length (裸铜长度)	S1	4.8±0.5
	S2	3.0±0.5
Conductor 导体	Tin Plated Ø0.5	
Insulation 绝缘胶	50UM PI YELLOW FILM	
O.V	≤0.7	
C.B	≤0.3	
RoHS Compliance		

YELLOW	C052027-XX
COLOR	PART NUMBER

THIS DRAWING IS A CONTROLLED DOCUMENT.		DWN G.W YANG 01JUL2021	CHUFON TECHNOLOGY CO., LTD.	
DIMENSIONS: MM		CHK ALEX LIN 01JUL2021	NAME RFC-0*1*64.8 (4.8/3.0, Ø0.5)	
TOLERANCES UNLESS OTHERWISE SPECIFIED: 0 PLC ± - 1 PLC ± 0.30 2 PLC ± 0.20 3 PLC ± 0.15 4 PLC ± - ANGLES ± 3'		APVD ALEX LIN 01JUL2021	PRODUCT SPEC	
MATERIAL SEE NOTE		QUALIFICATION TEST REPORT		RESTRICTED TO -
FINISH SEE NOTE		WEIGHT A3 00779	SIZE A3	CAGE CODE 00779
		DRAWING NO C052027		SCALE -
		CUSTOMER DRAWING		SHEET 1 OF 1
				REV A0